

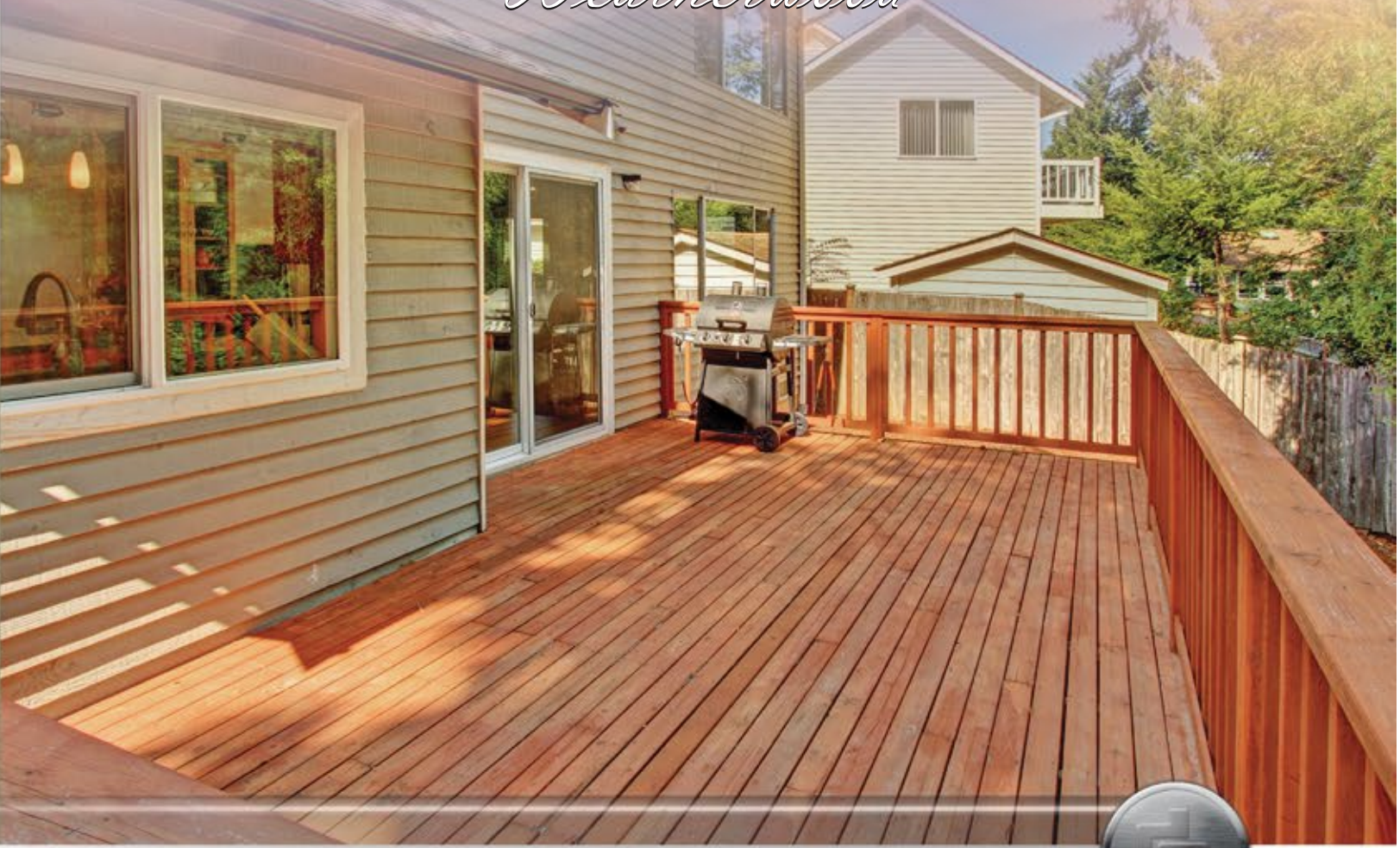

Weatherwood



Delight the senses with style...



Stylish remodel with meticulous attention to detail. Double height foyer and wrapping staircase to the upper level. Benjamin Moore Designer paint colors throughout help to create a restful mood of calm and tranquility. The custom kitchen is the center of the home. Design elements include honed green galaxy granite slab counters, custom "lyptus" cabinetry and custom tile backsplash accents. Undermount sink and KitchenAid stainless appliances. Designer inspired swirling glass fronts on specific cabinetry to tie together with the slab granite's natural grain. Pendant lights of blown glass accent the kitchen island. The rich hardwood flooring creates a warmth and flow throughout the entire main floor. The family room is a gathering spot and natural extension of the kitchen and entertaining space. Cascading backyard deck is perfect for entertaining and an open lawn provides ample play space. Privacy abounds in this greenbelt backyard. Large master suite with sitting area looking out over the greenbelt. The Master Bath includes a full five piece ensemble with soaker tub, separate shower stall, his and her vanities, and water closet. Whole house upgrades include: Wainscoting, crown moulding, nickel lighting, hinges, and hardware throughout. 40 year Elk HD roofing installed by Legacy Roofing contractors. With a wonderful neighborhood, great location, and an excellent school district... call Doris today!



Doris Ong Windermere REAL ESTATE

4526 186th Avenue SE Issaquah, WA 98027

For More Information or for an appointment to see, call: 425.890.2087

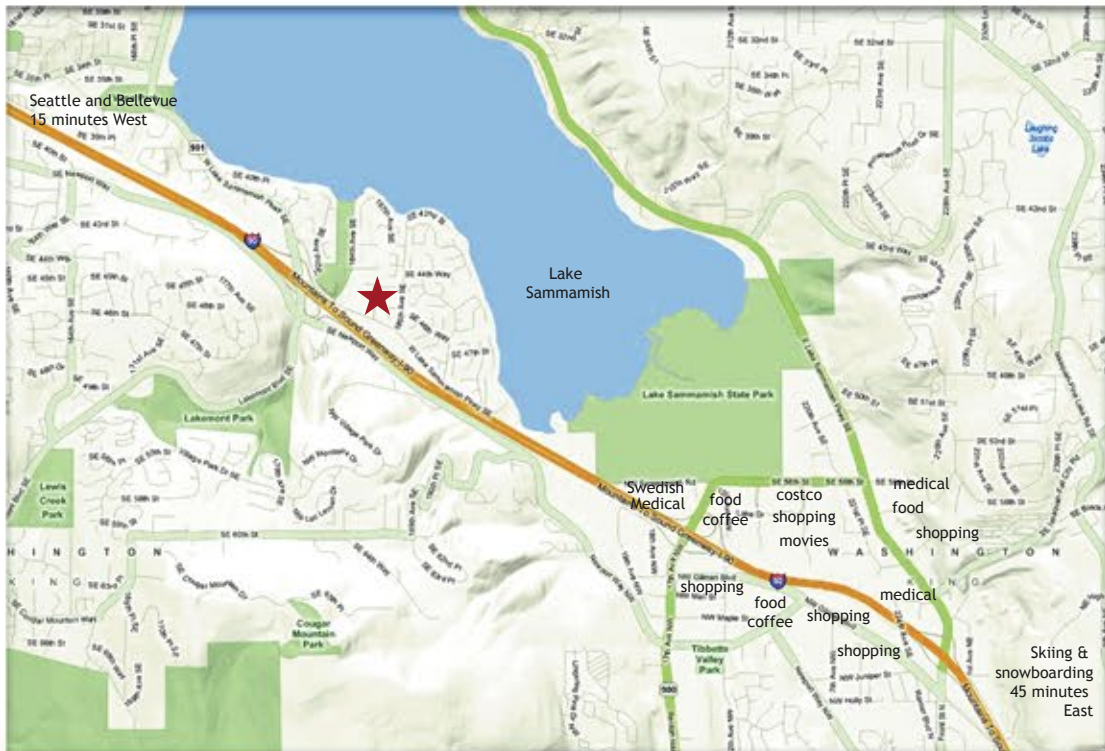

4526 186th Ave. SE Issaquah, WA 98027

MLS# 695927 Offered at: \$609,800

3 bedroom 2.5 bath Year Built 1987

Living: ~2000 sf Lot Size per kcr: ~7481 sf

2014 Taxes: \$4,943



425.890.2087

e-mail: homes@dorisong.com

www.dorisong.com

 Windermere
REAL ESTATE